

Fireside Chat



Photo Editing New Things and Tips and Tricks

Joe Gilchrist

March 17, 2025

Agenda

- New Additions to Lightroom Classic (LRC) and Camera Raw (CR)
- Enhance options found in LRC and CR, Denoise and Super Resolution
- Masking in LRC and CR
- Lens Blur
- Fixing Leaning Buildings in LRC and CR
- Remove Tool in LRC, CR and Photoshop
- Create a Develop User Preset in Lightroom Classic (LRC)
- How to create Export Presets in Lightroom Classic (LRC)
- Photoshop Quick trick to Add a Boarder and Export to JPG
- New General Features. Deletion of Backups and Rename a Catalog

Lightroom Classic Library Module

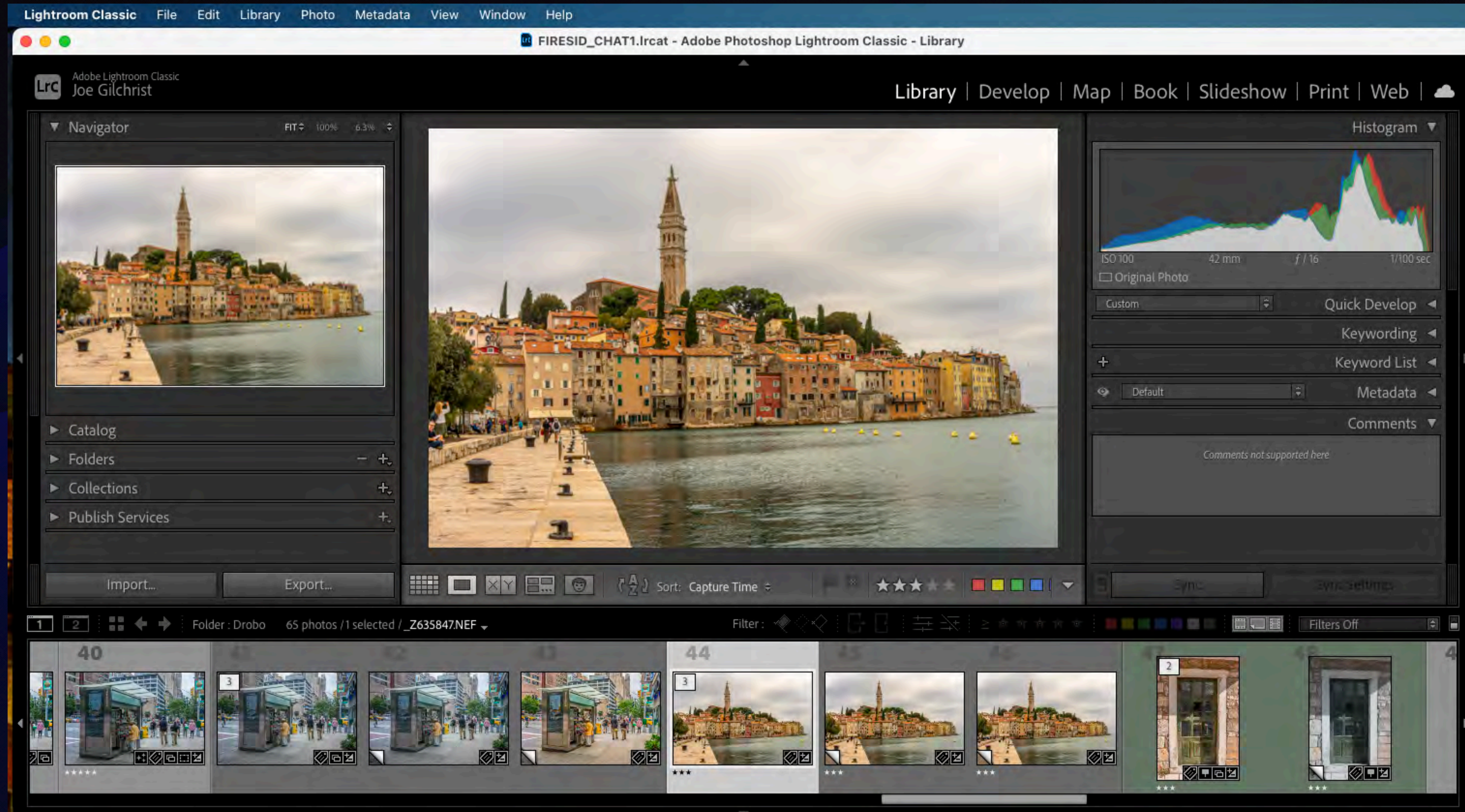

Lightroom Classic Develop Module



Lightroom Classic Developer Items Covered

Lightroom Classic File Edit Develop Photo Settings Tools View Window Help

Enhance

Library Module Panels

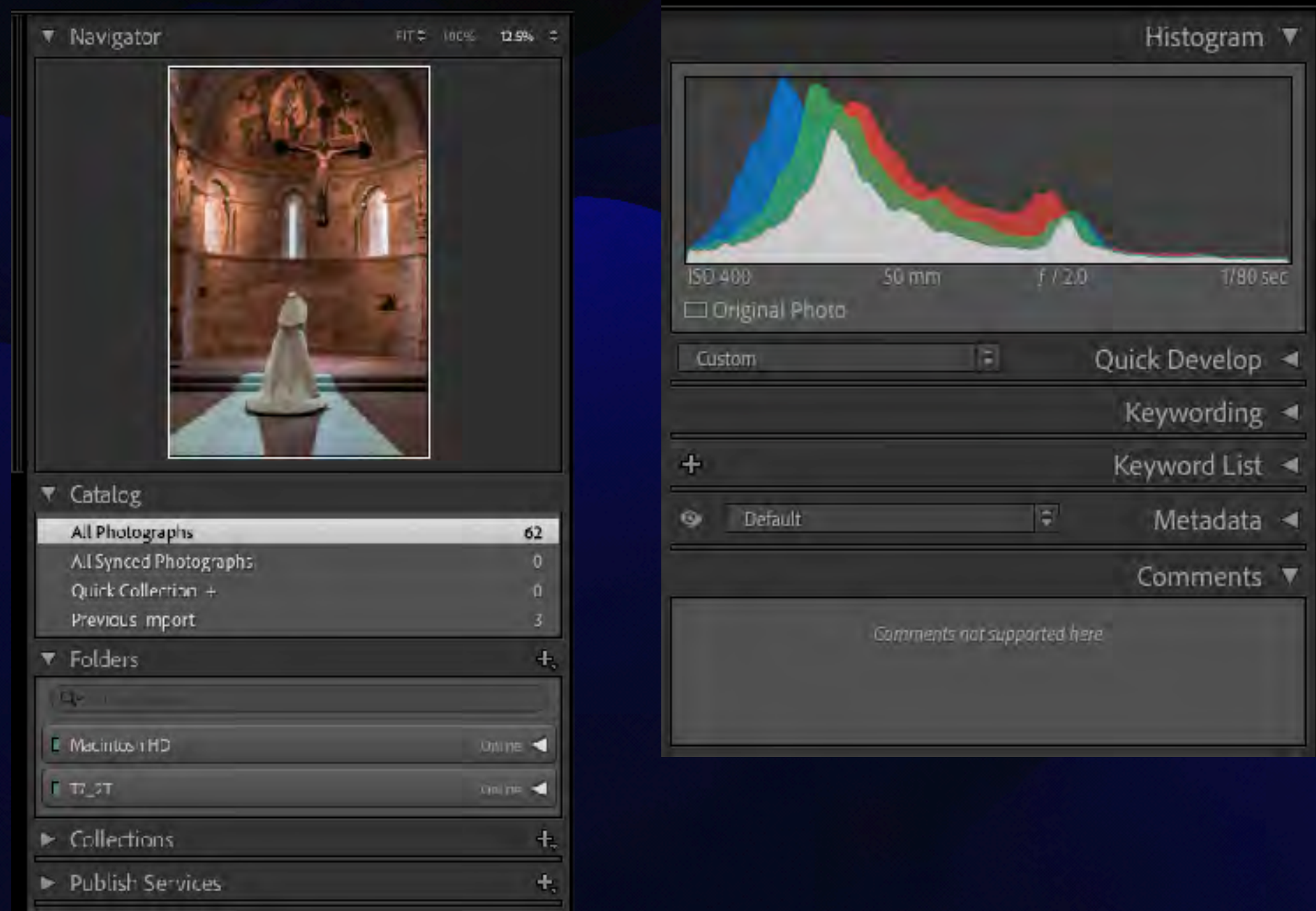

Develop Module Panels

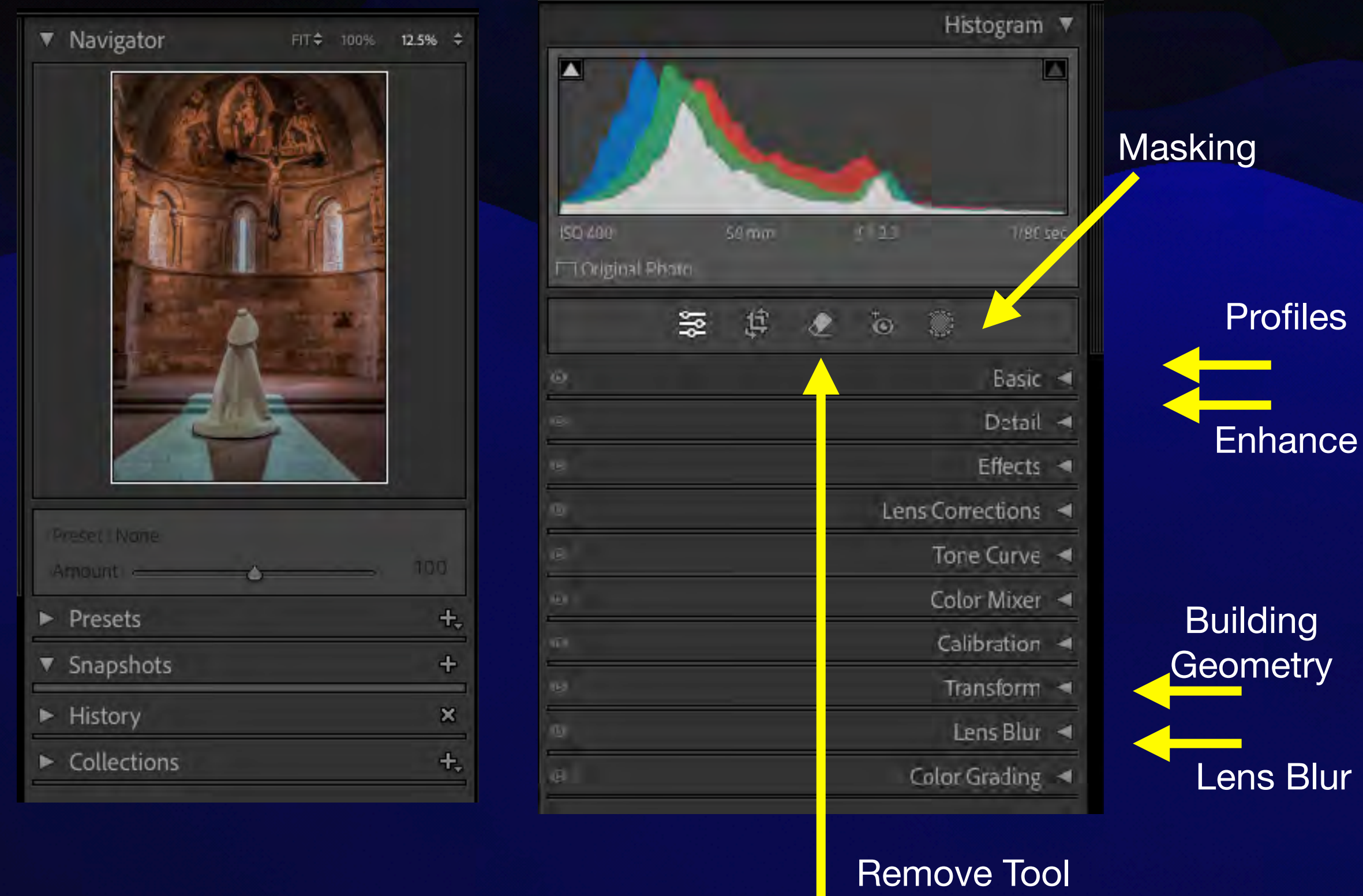

New Profiles added to LRC and CR Adaptive Color and Adaptive B&W Profiles

There have been two new profiles added to LRC and Cr

They are Adaptive Color and Adaptive B&W.

They employ AI to look at images and apply changes that it finds will enhance the image.

These profile are analogues to the Auto. However you should not use Auto with these profiles.

They may not be appropriate for all images. You may want to experiment and see if the results give you the desired starting point to you editing.

Lightroom Classic

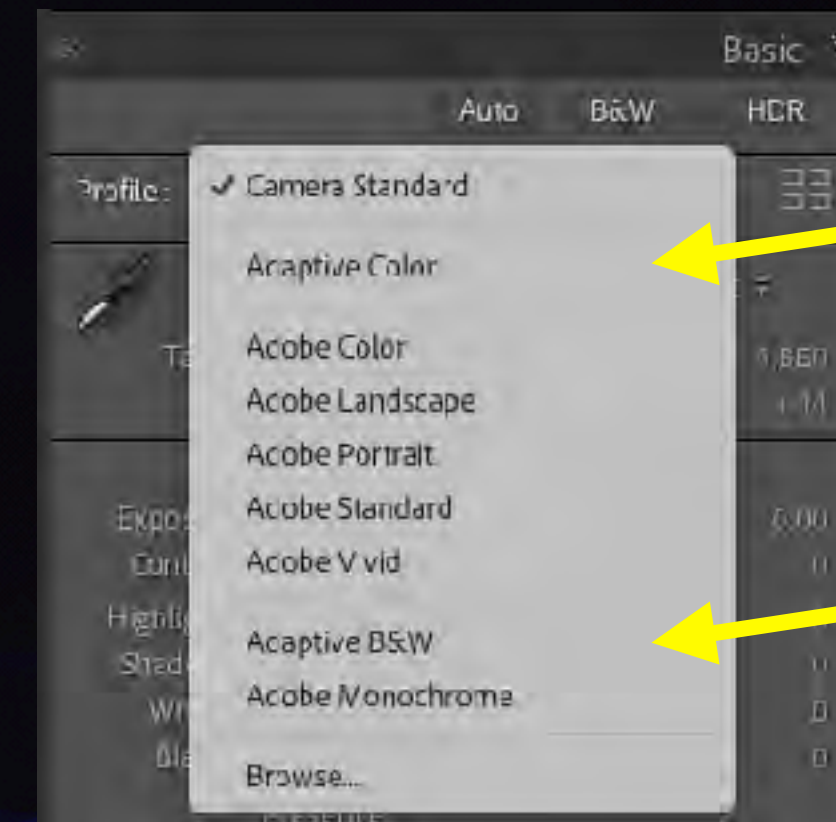

Camera Raw

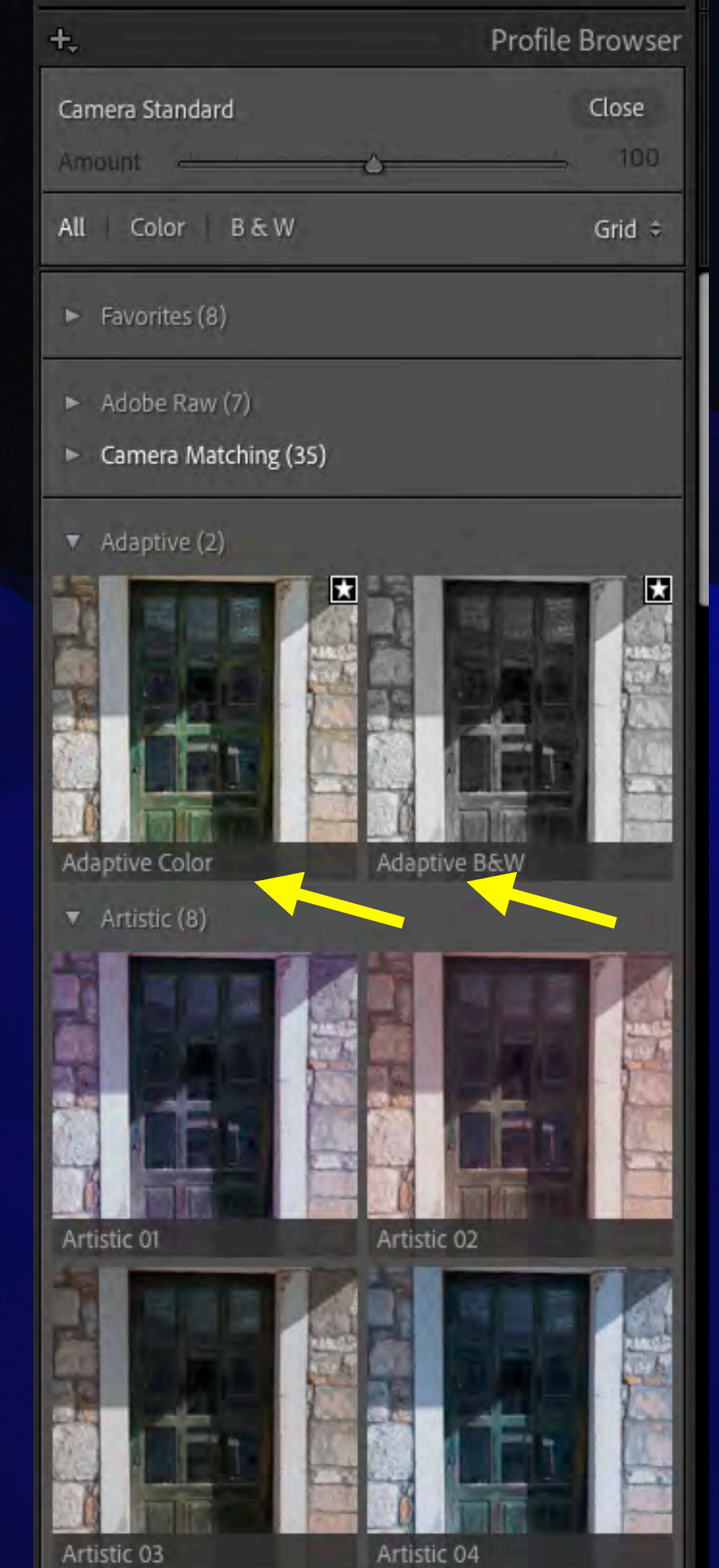

Enhance Options: Denoise or Super Resolution

Lightroom Classic

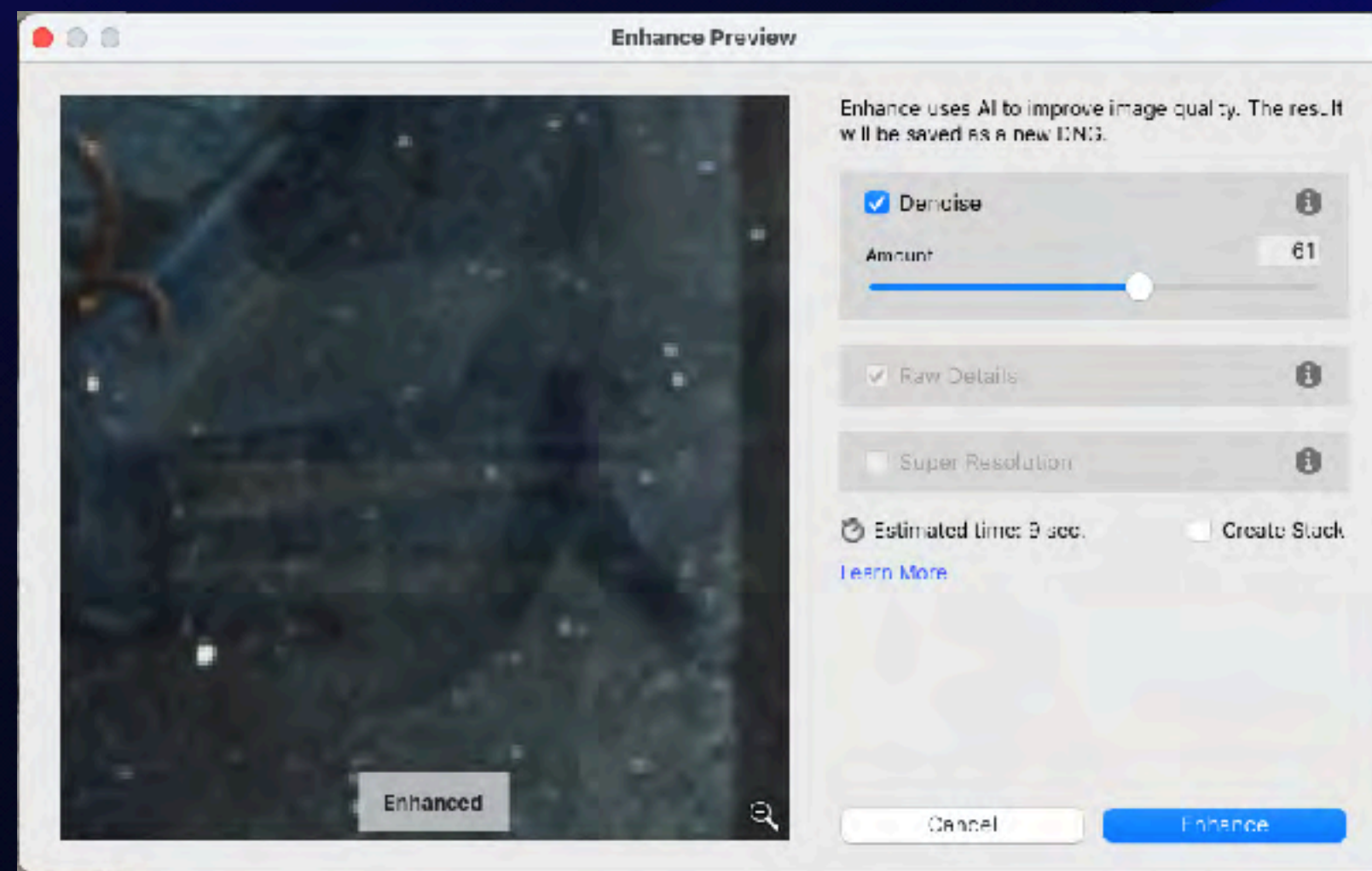
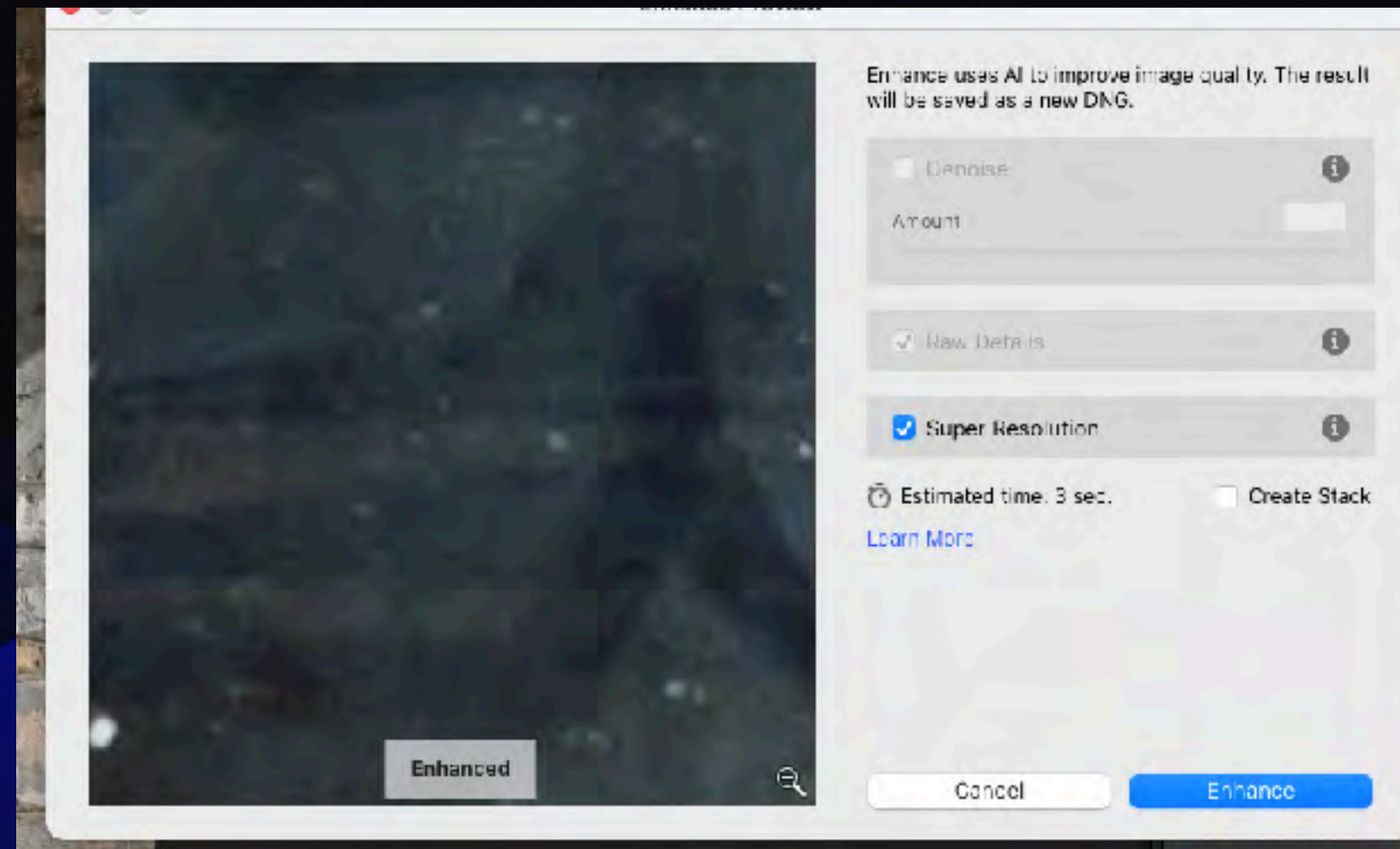
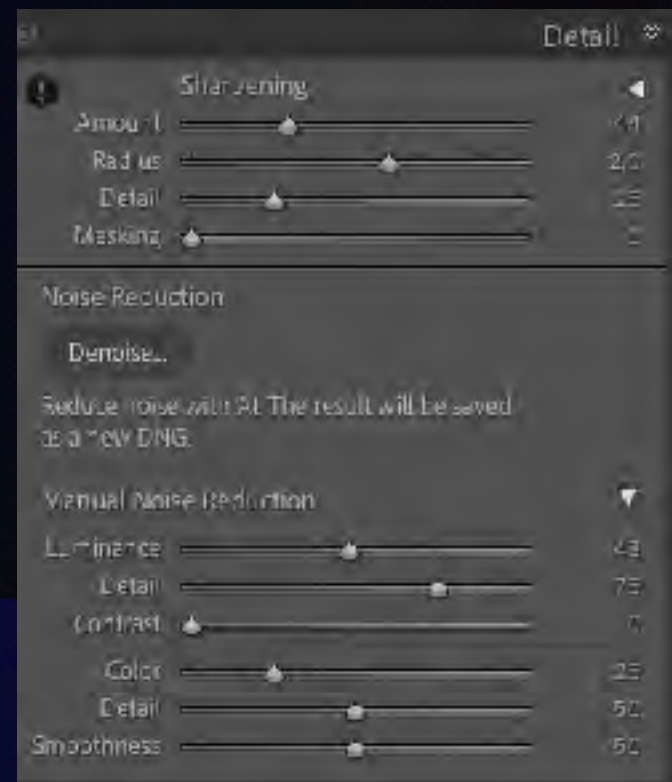

- **Denoise**: will clean up noise found in your files.
- **Super Resolution**: will double the size of your image

In Lightroom Classic there are 2 places to access the enhance options. **Works on Raw Images Only.**

1. The easiest is to go to the Detail section of the Lightroom Develop module where you will find the **Denoise** button and it will open dialogs that look similar to these to the left. The **Enhance** option may be accessed thru the Photo menu also.
2. You may check the **Denoise** check box to select the **Denoise** option or the **Super Resolution** check box.
3. It will give you a preview of the changes so you can change the Amount slider to get the desired Noise reduction. Most useful for noise reduction option
4. Click **Enhance** to apply the select enhance mode. A .dng file will be created with a NR for noise reduction or SR for super resolution included in the name.

Camera Raw

In Camera Raw both options may be found in the detail section of develop.

To access the **Denoise** option check the **Denoise** check box. An **Amount** slider is available but no preview is provided.

To select **Super Resolution** check the **Super Resolution** check box.

Results are stored in a sidecar file with an extension of .acr.

Camera Raw

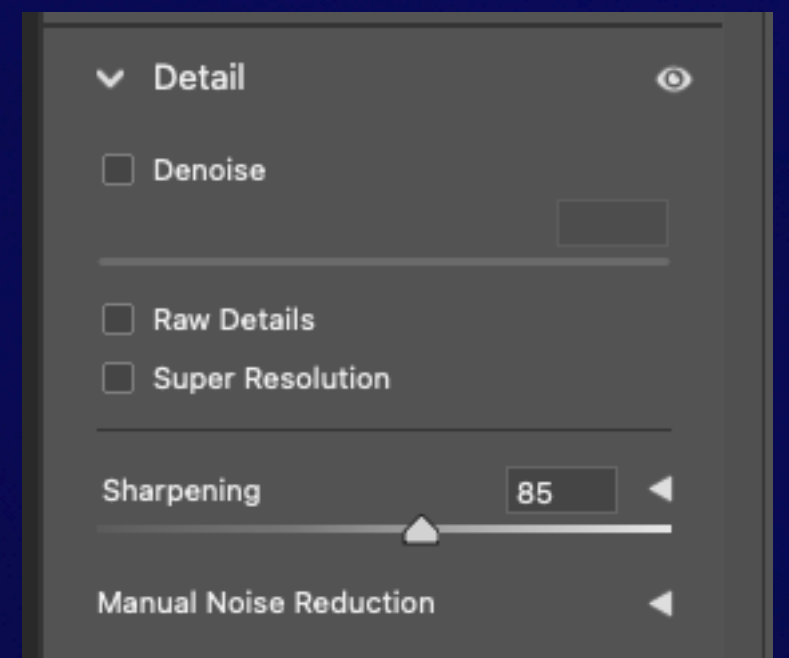

Masking Options in Lightroom Classic

Lightroom has number of options available for creating Masks

- **Subject:** detection will select what Lightroom determines to be the subject of your photo.
- **Sky:** detection will select the sky in your image.
- **Background:** detection will select what Lightroom determines to be the background in your photo. Useful in making backgrounds harder or removing clarity and/or texture.
- **Object:** detection will require you to paint over the thing you want to select.
- **Brush:** allows you to use the paint brush and create a mask only where you have painted.
- **Linear Gradient:** is similar to using graduated filter on the lens. You may place these gradients in a number of orientations. Top-to-Bottom, Bottom -to-Top, Side-to-Side or Corner-to-Corner.
- **Radial Gradient:** allow you to create circular or elliptical mask. Helping to enhance certain Areas.
- **Range:** have three options. The two that are available are the
 1. **Color Range:** that will allow you to select a color to mask. A slider ti provided to increase or decrease the range.
 2. **Luminance Range:** will allow you to use a brightness range from your image. Like highlights or shadows.
- Any of these masks may be inverted to change the select area to be the unmasked area.

Lightroom

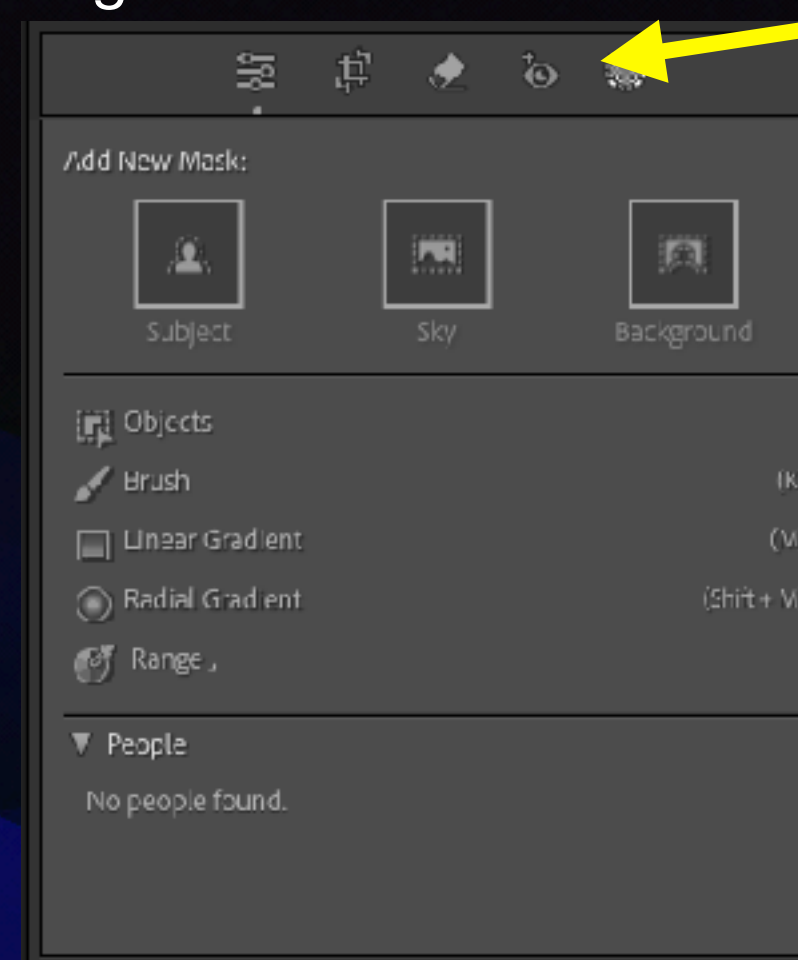

Camera Raw

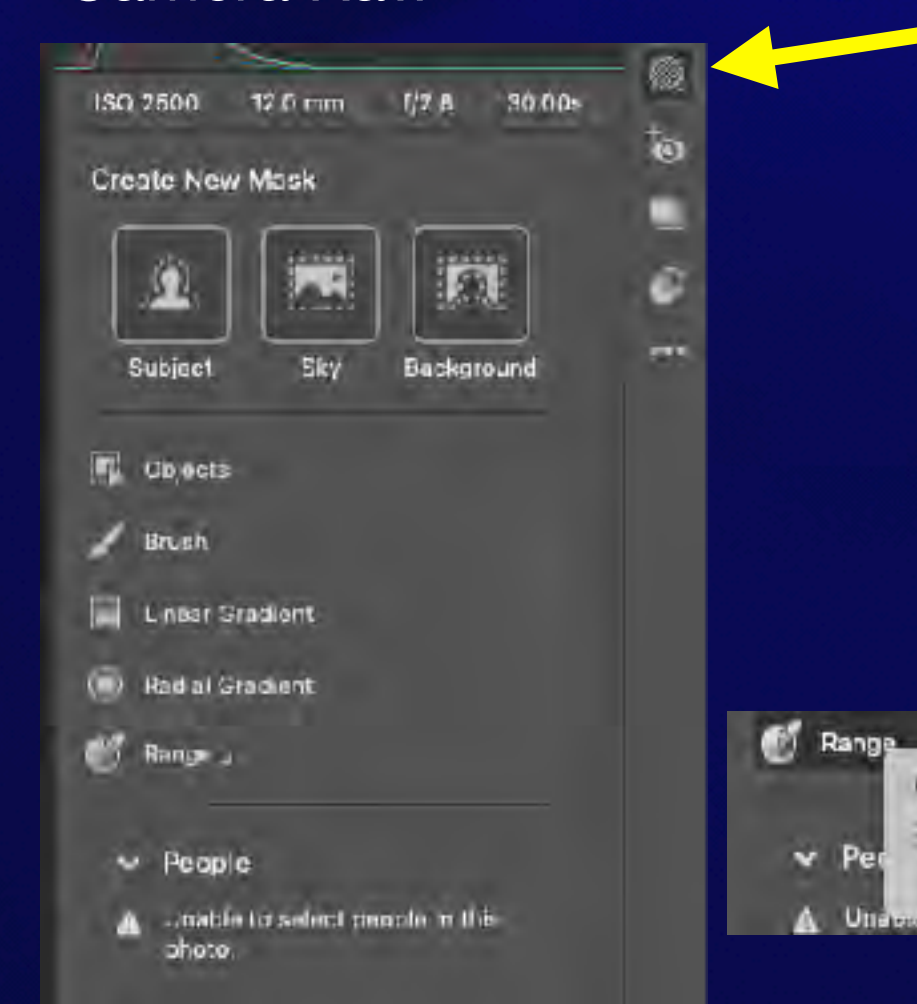

Lens Blur in LRC and CR

Camera Raw
Lens Blur



Apply Check Box checked
adds the blur to the image



Lens Blur in LRC and CR Cont'd

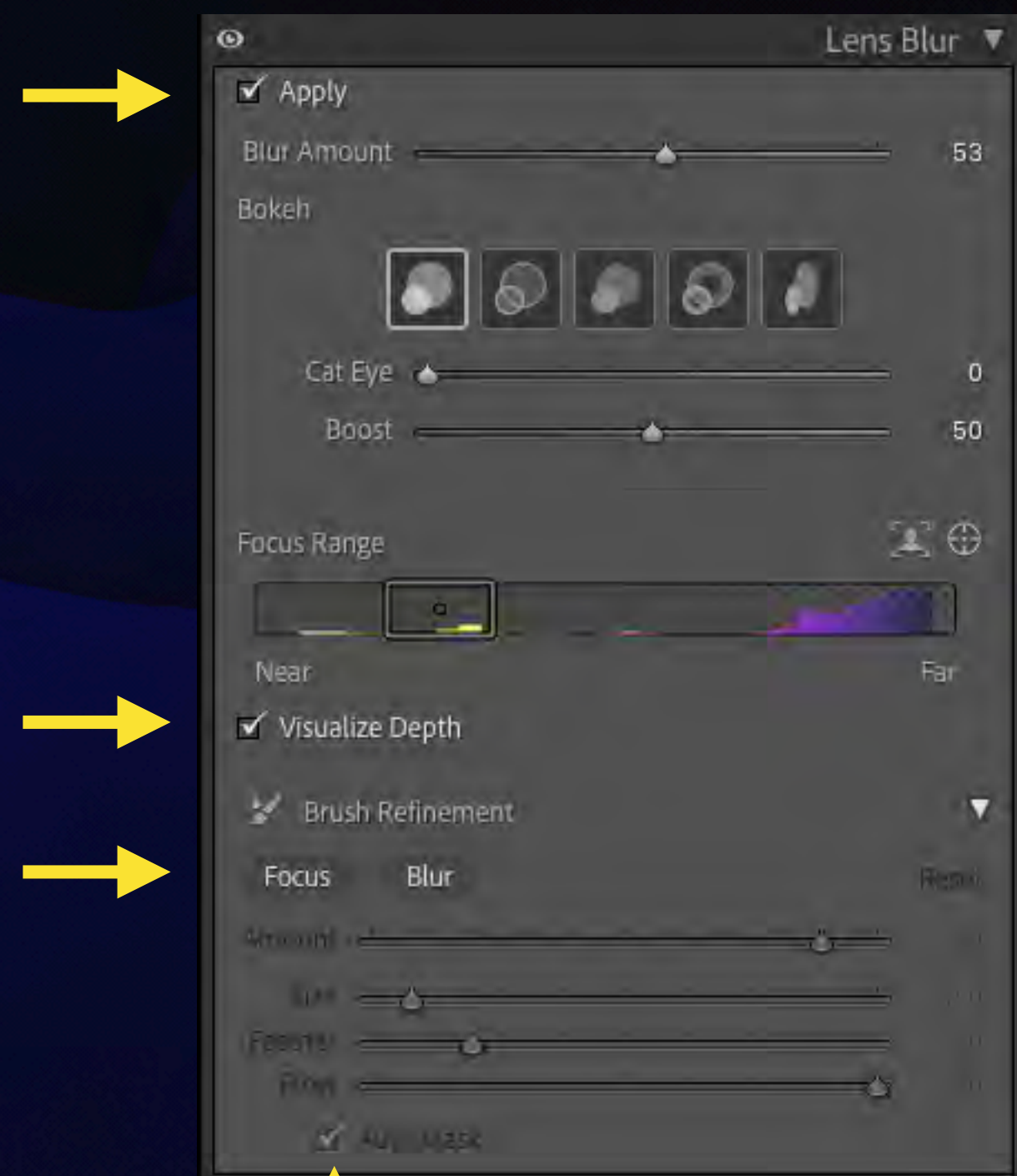

Use this to help restrict your mask



Apply Check Box checked and Visualize Depth checkbox checked



Brush to add focus to another area more in the background



Brush to add Blur to other area other areas in the image

Fixing Leaning Buildings in LRC and CR

Lightroom Classic



Adobe Camera Raw



Fixing Leaning Buildings in LRC and CR Cont'd

- **Auto**: Lightroom or Camera Raw will decide what to do to the image.
- **Level**: again Lightroom or Camera Raw will decide how to make the image level.
- **Vertical**: mode again Lightroom or Camera Raw will make the change to the image.
- **Full**: mode similar to auto with Lightroom or Camera Raw making the decisions.
- **Guided**: will have you draw guides along the parts of the photo you want to change. This is usually accomplished by using multiple guides drawn on an image and applied.
- A set of Transformation sliders provided so you can either manually correct the image or make changes to the automated or guided modes.
- By selecting off you will remove the automated changes

Remove Tool Options in LRC, CR and Photoshop

There are differences in the Remove tool options in LRC, CR and Photoshop. At this time LRC has the least options to select from. I would expect to see the updates in CR to be added in a future LRC version.

Lightroom Clasic

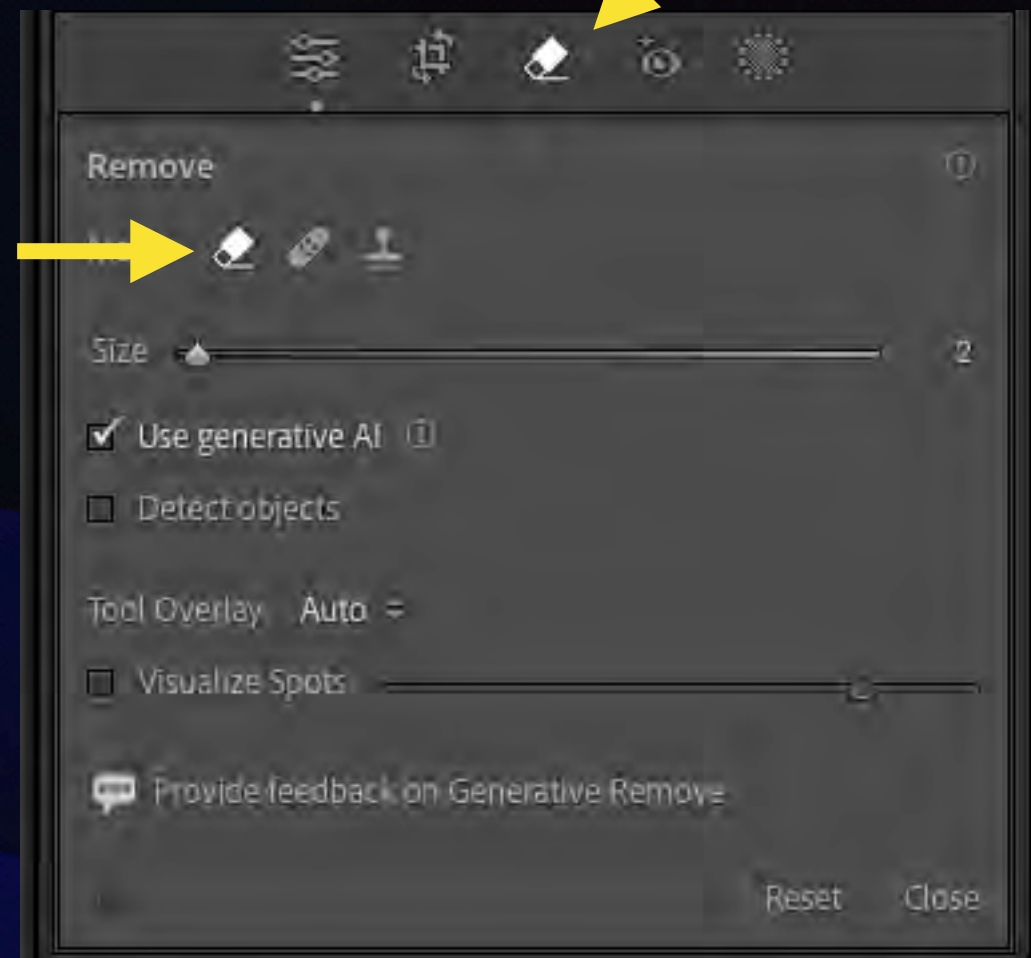

The following slides will show examples of each editors capabilities.

Lightroom has the least options for removal. You may paint over the object you want to remove and it may not always do what you want it to do. It may use AI to fill in.

Camera Raw has the ability to detect people in an image that can be considered distractions. It does a good job in removing them. It has a new option that can remove reflections from shots taken through windows.

Photoshop has the find distractions that has two select targets. People and Wires and Cables. The People works like the Camera Raw method. The Wires and Cables is a nice addition. Since Camera Raw can be used as a filter in Photoshop the **Reflections** removal is also available.

In Photoshop and Camera Raw the removal options are a single click. The CR and Photoshop replace tools work much better and are more consistent and reliable than Lightroom currently.

Adobe Camera Raw

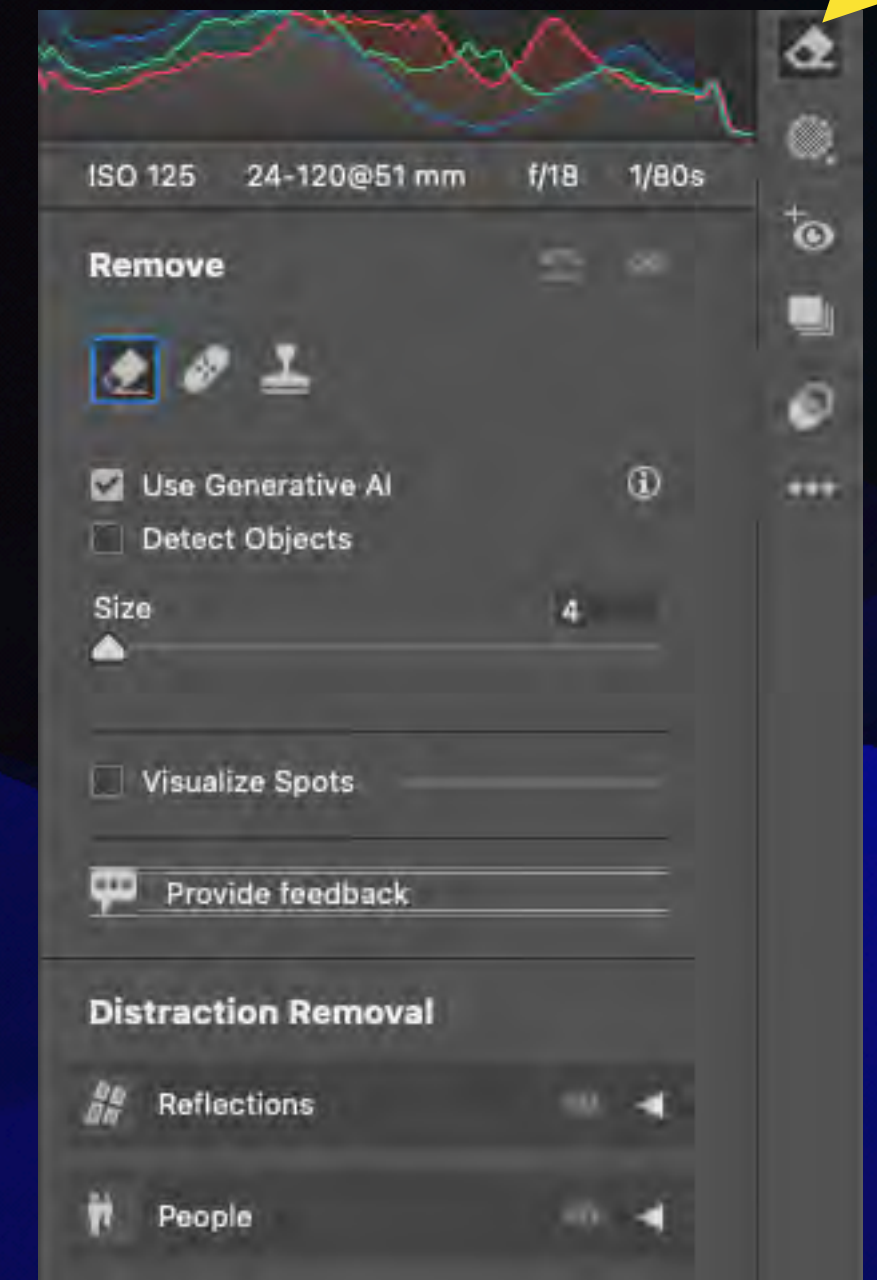

Adobe Photoshop 2025

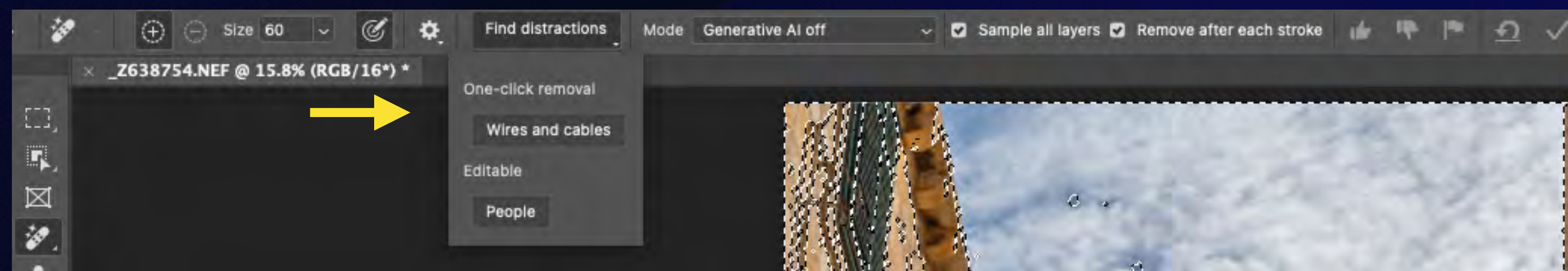

NOTE: Changes in Lightroom are stored in a sidecar file with an extension of .xmp. While, changes made in Camera Raw are stored in a sidecar file with an extension of .acr. Changes made in Camera Raw are not visible to Lightroom from what I can see

Remove Tool Options in LRC

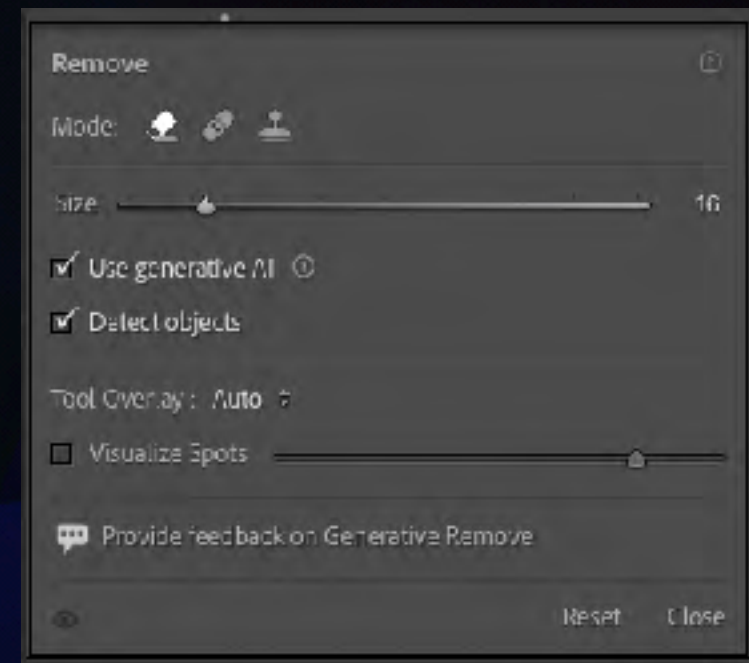

I was not satisfied with the taxi options provided. It did a good job with the other 2 people after a number of tries



Did not replace the person but added another

Remove Tool Options in LRC Cont'd



Lightroom did a good job of removing the people here with brushing on the people in this case.



Remove Tool Options in CR

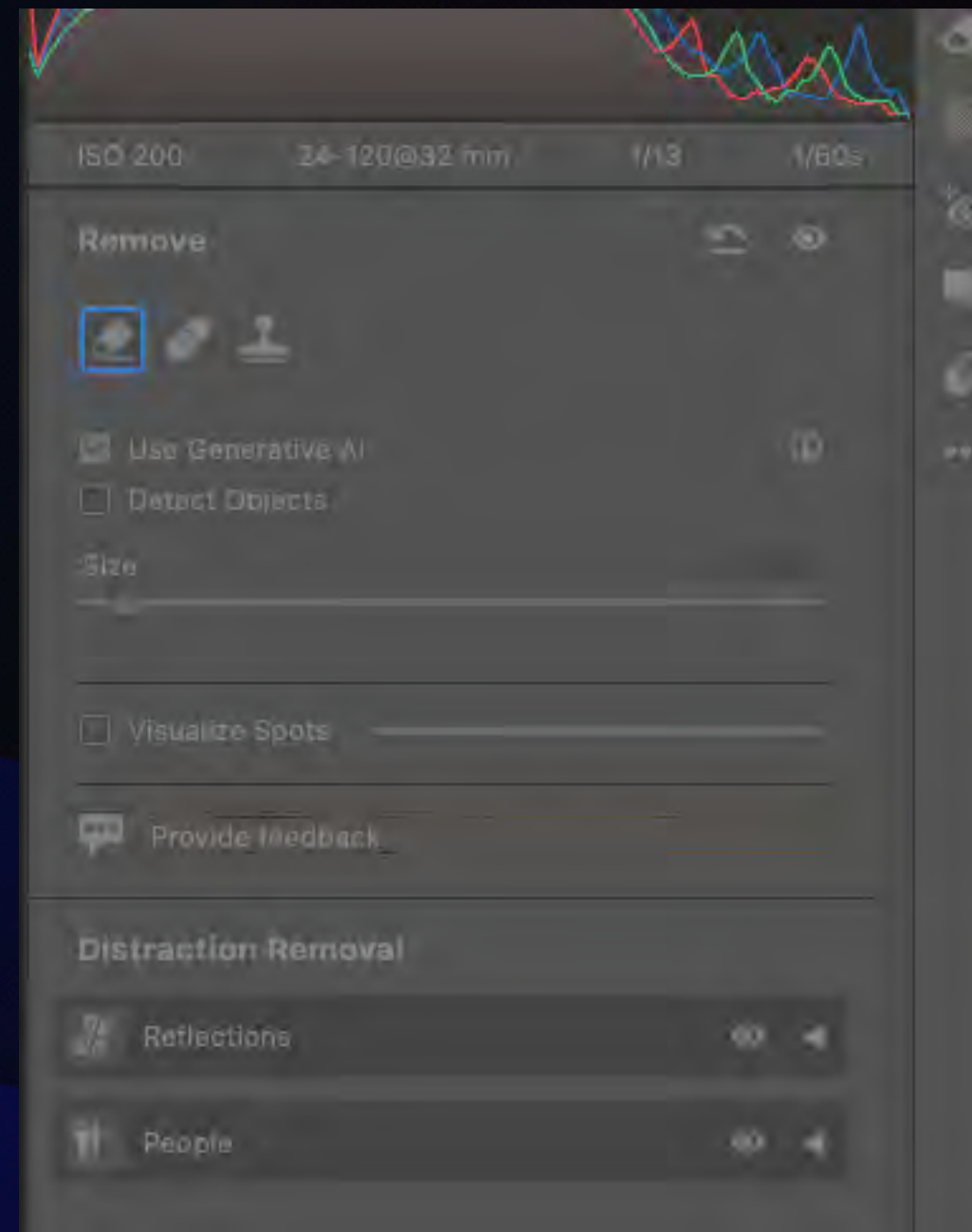

CR did a good job on identifying the distracting people. In the upper Image I did try to remove other people but I did not get favorable results. The taxi had a better result In the lower image it detected more people and the replacement was good as shown



I will demonstrate the Reflection removal but I do not have a good example

Remove Tool Photoshop

Adobe Photoshop 2025

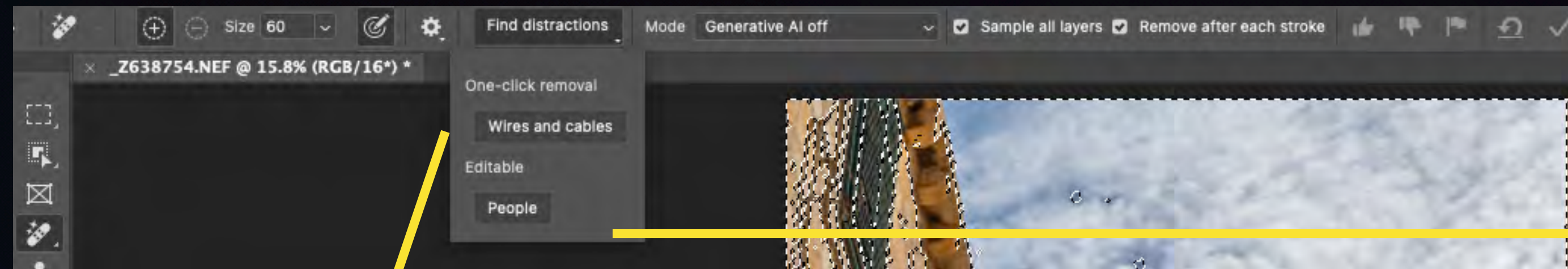

Wires and Cables



People

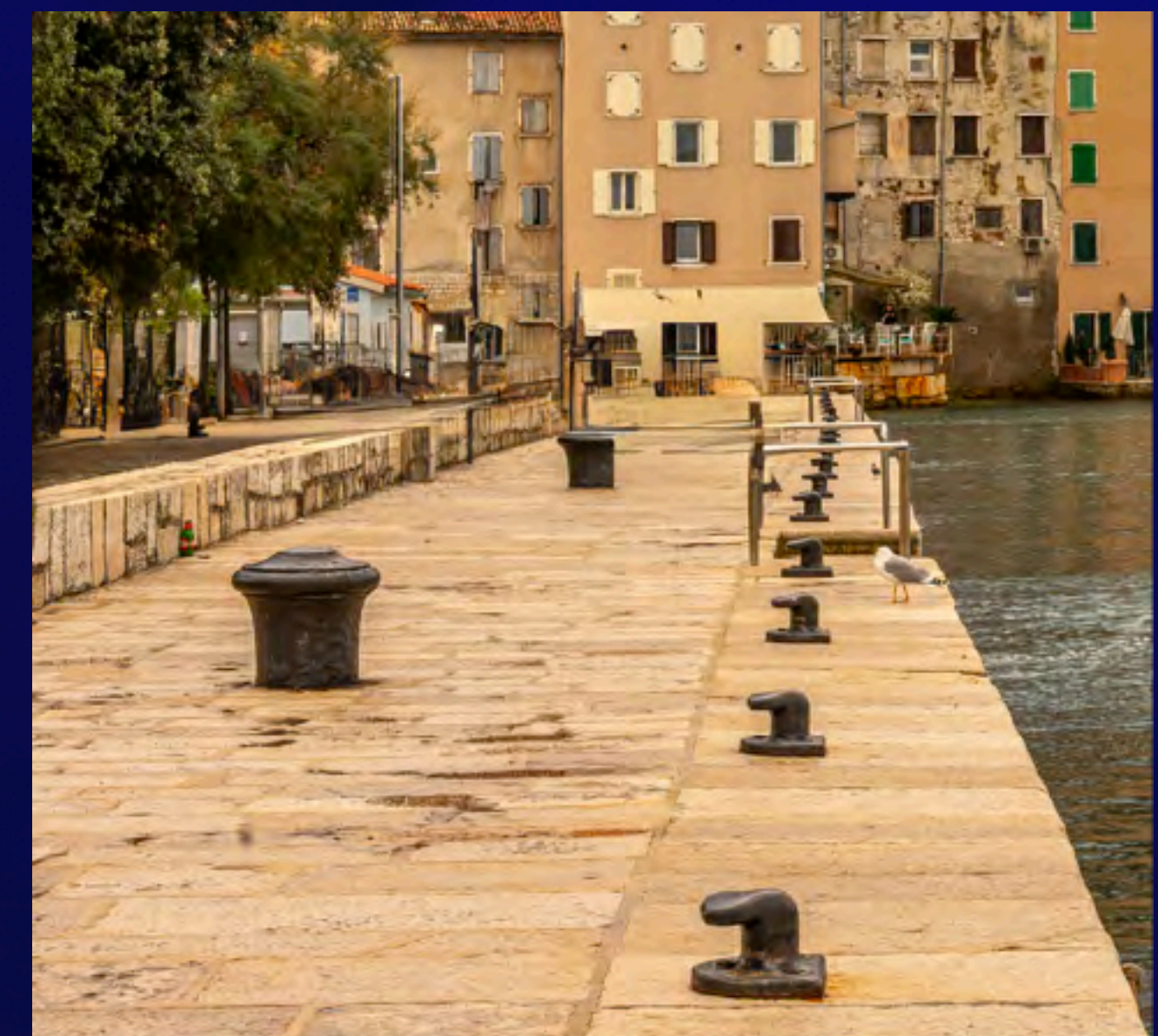

User Development Preset in LRC

- What is a Develop Preset? This is a set of develop module settings that you find yourself using on most of your images.
- What does it do for you? It helps simplify your workflow and makes it more efficient. One click and the settings contained in the preset are applied to your image so you can continue to fine tune the image using more of the setting in LRC or with plugins or further editing in Photoshop.

How to Create a User Development Preset in LRC

Set your development options

1



1. Once you have all the options set in your development panel, you may now add the new preset to User Presets.
2. Click the + to the right of **Presets**. This will open the dialog to allow you to name the preset and save it.

2

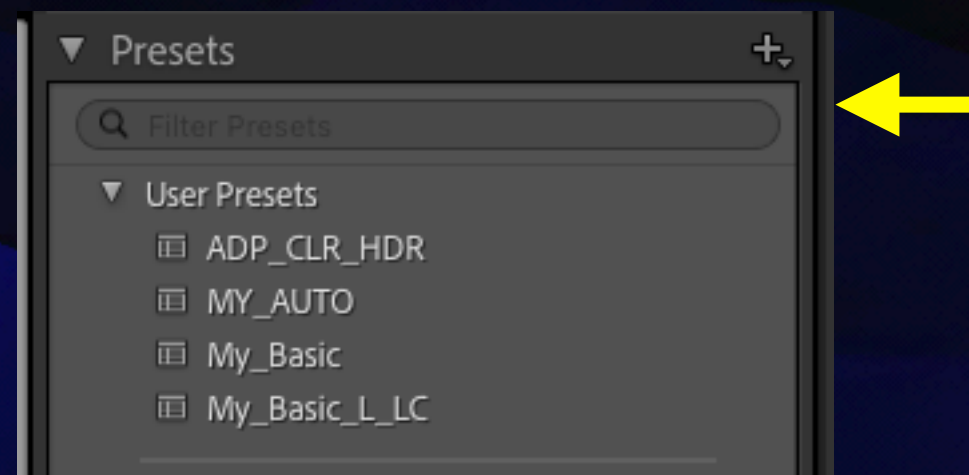

3. Once named click Close and you are done.

Your development options may include the various Profiles

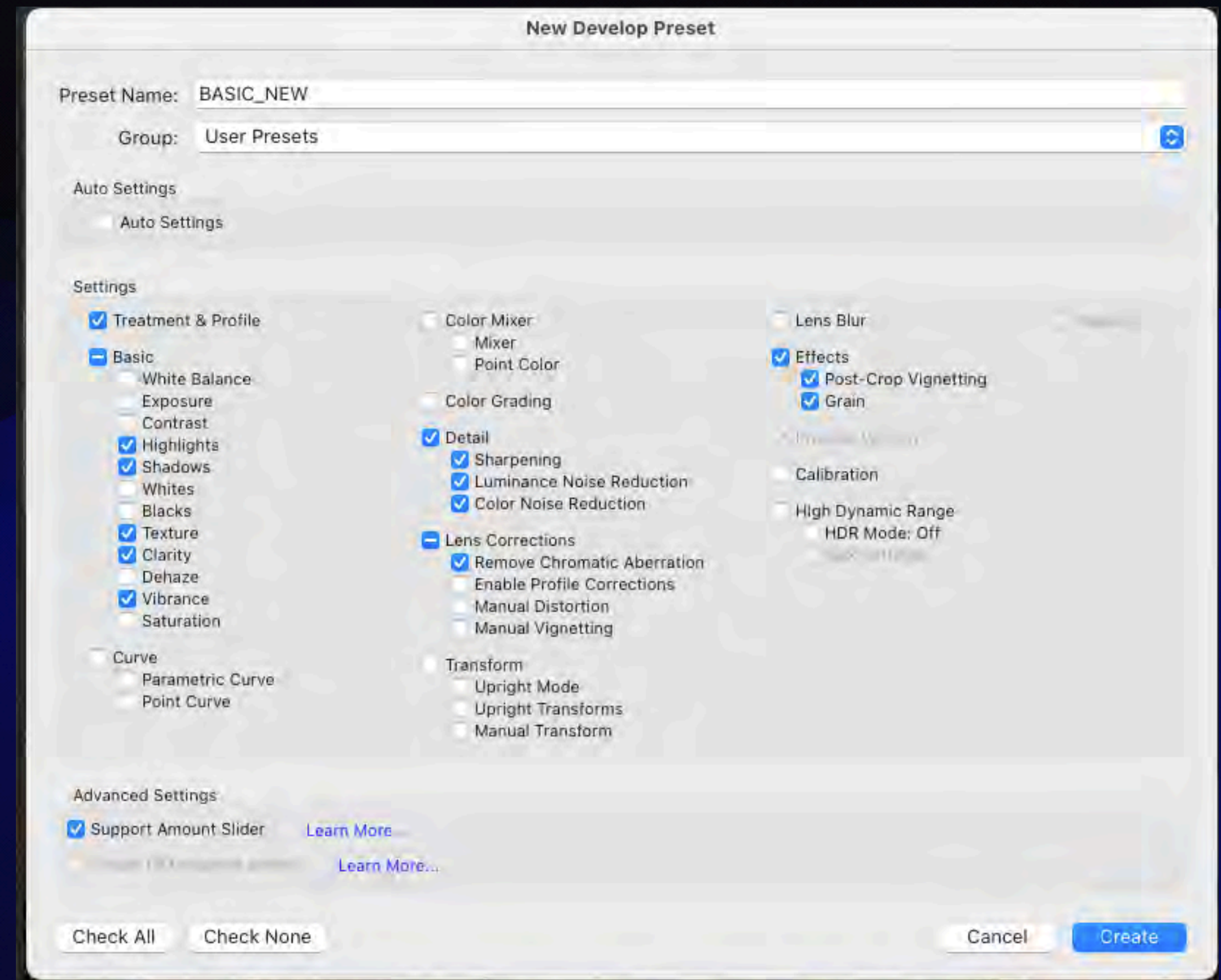
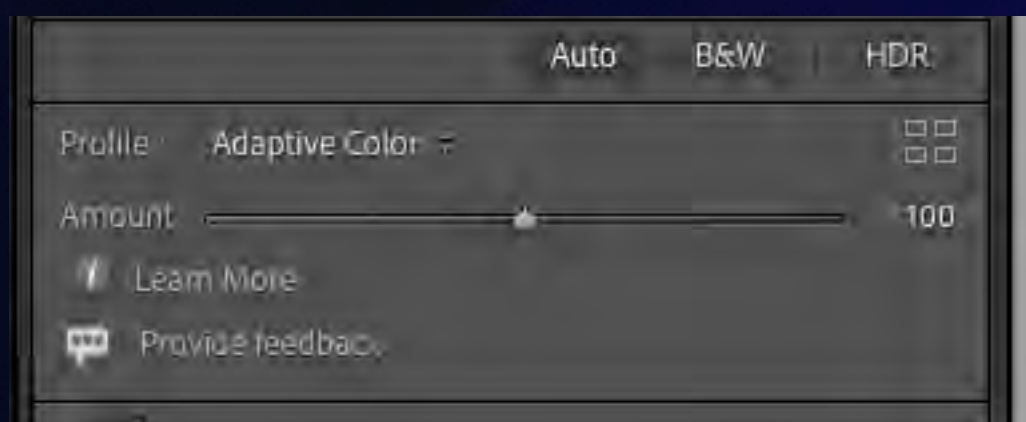

3

User Export Preset in LRC

- What is a Export Preset? This is a set of settings that get applied when exporting an image. This may include a directory/folder that you want to export. These may also include a water mark for non-competition exports.
- What does it do for you? This makes it easier to export images for the various competitions that we submit. For instance, our monthly companions use 1050 pixels on the longest side. This can be assigned in the preset and save for repeated use.
- Multiples may be made to correspond to the external compositions that we submit or for other uses.

How to Create an User Export Preset in LRC

- In the Library in Lightroom find the Export button
- Click the button and it will open the Dialog found on the next slide

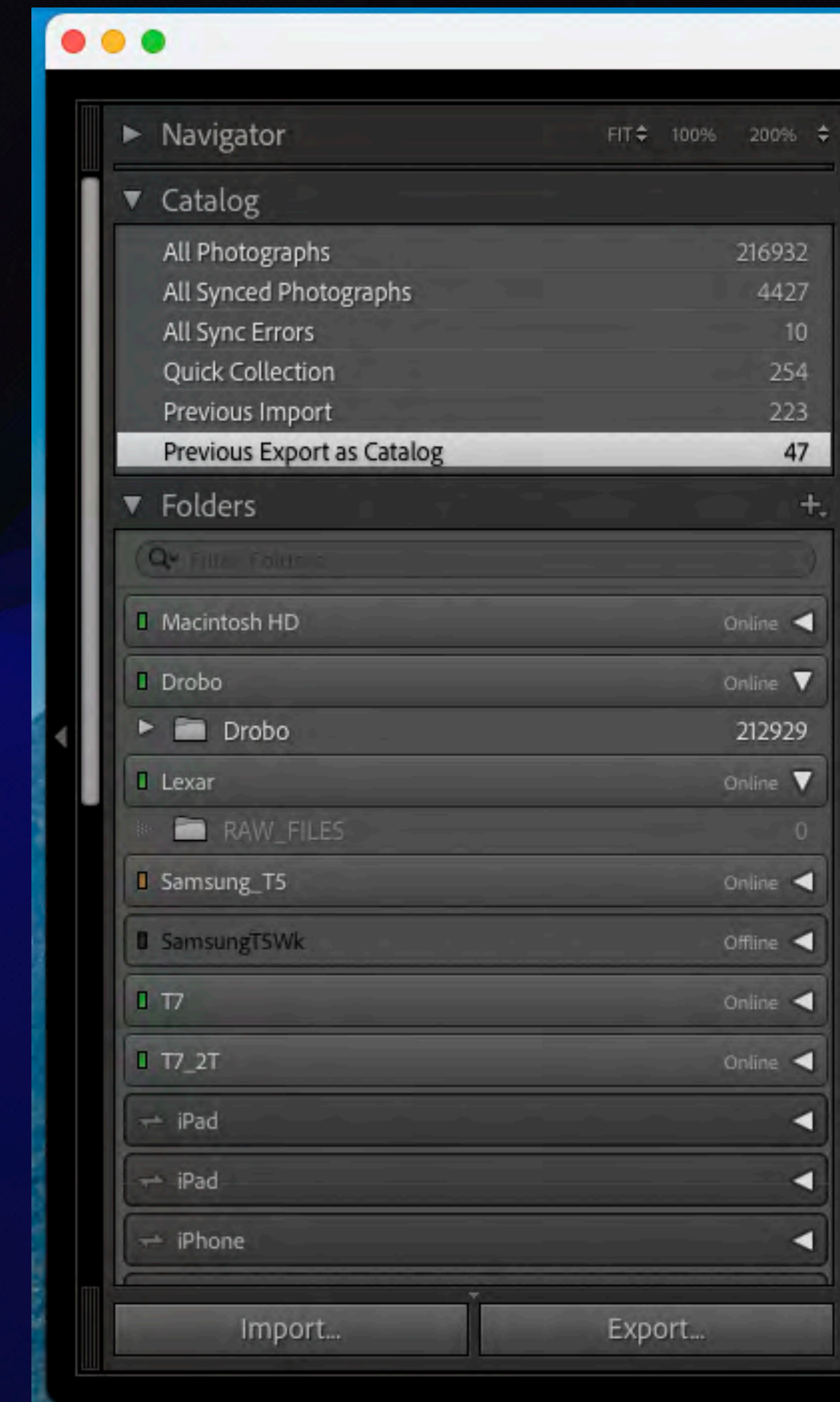

How to Create a User Export Preset in LRC Cont'd

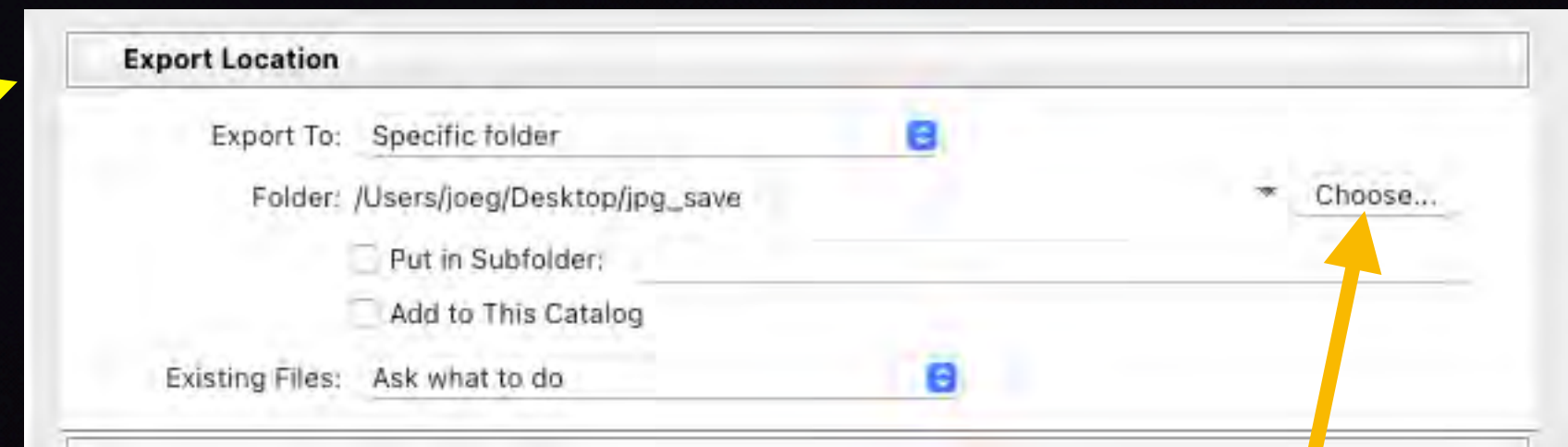
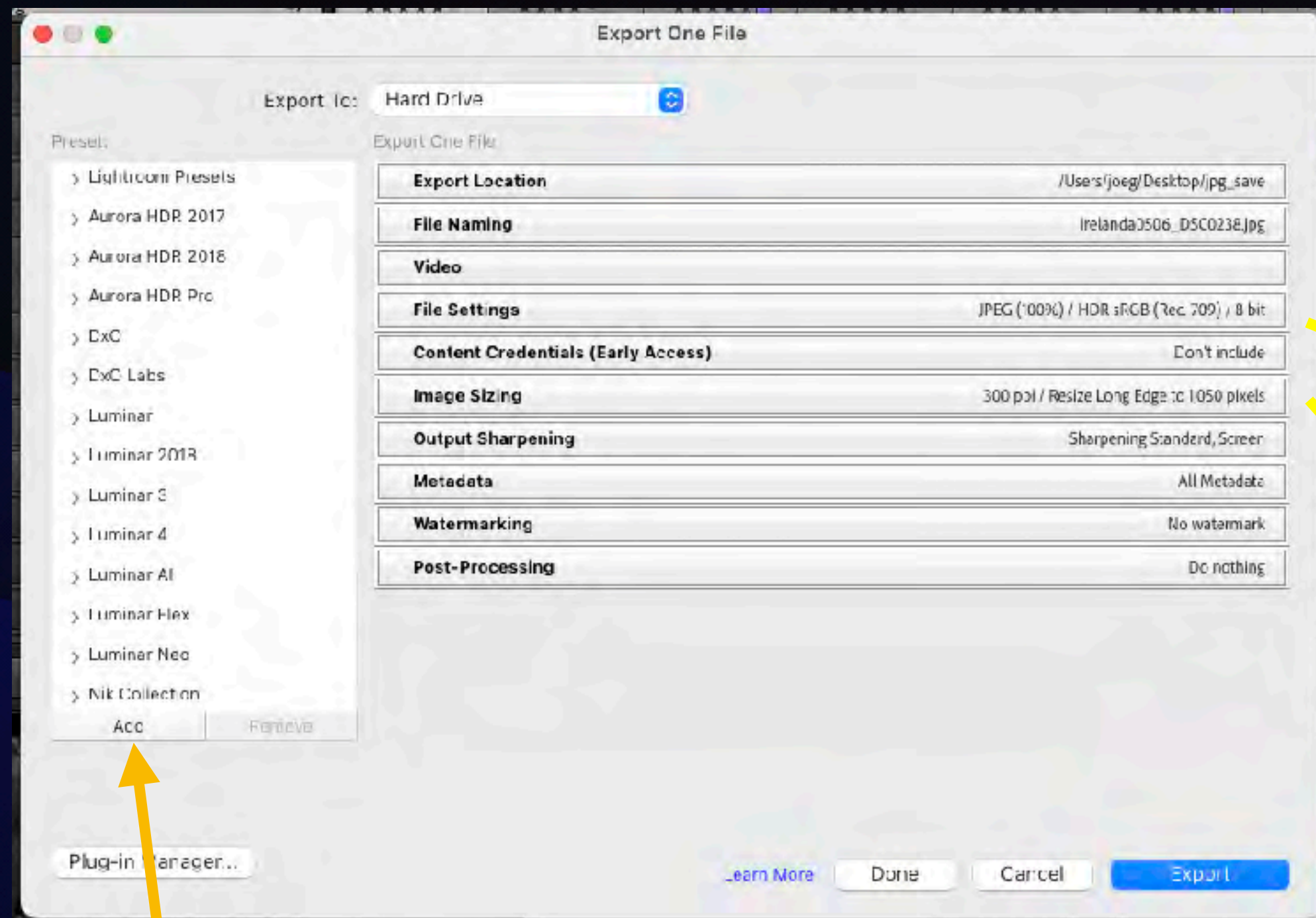

1 Identify and set the location to export your files. Each preset may have different destination

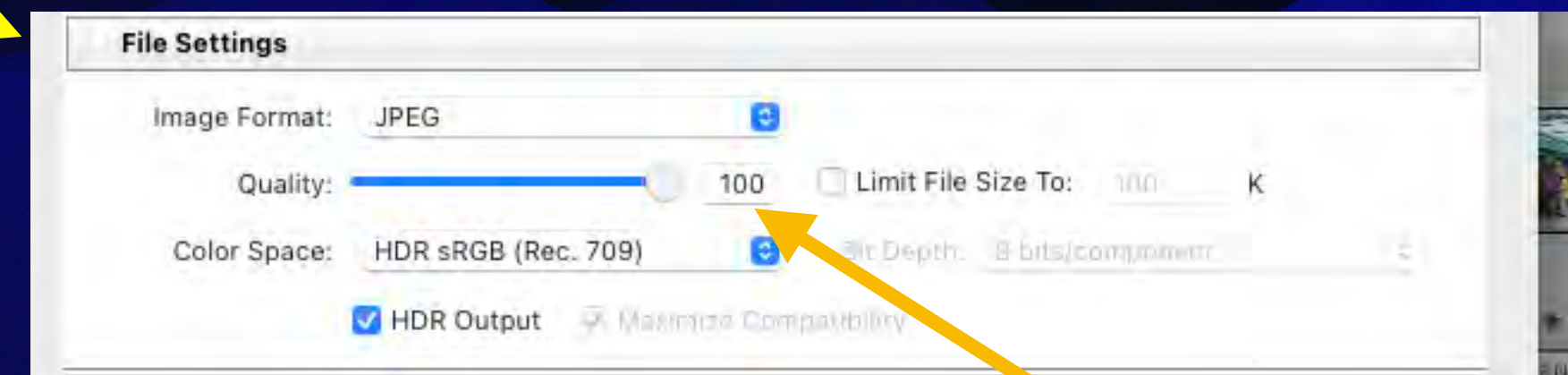

2 Set the Quality of your JPEG export. You can also limit it to a size if you output gets too large. It allows to set export of color space for HDR Monitor support

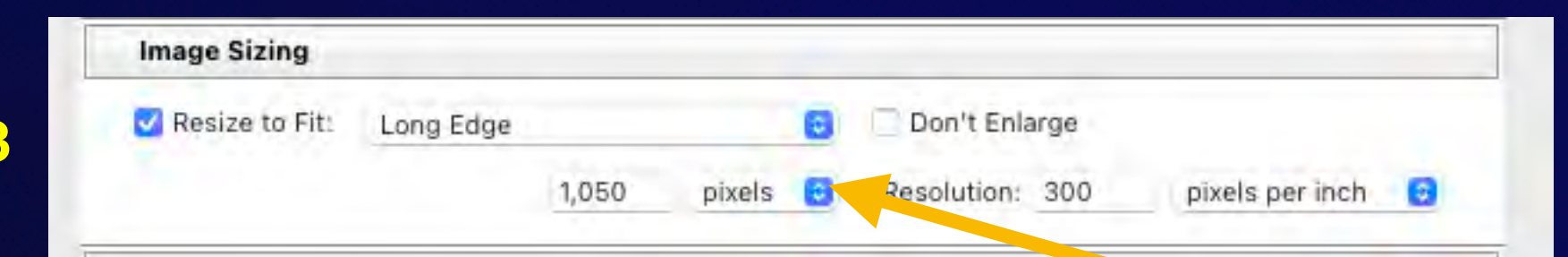

3 This is where you set the output size. Select Long Edge from the Resize to Fit dropdown. Set the size to 1050 pixels or to the appropriate size for the export



4 Click the Add button and give the preset a name. Then Click Create and your preset is saved

Easy Step to Add a Border and Export Using Photoshop

1-2



1. In LRC select the image that you want to apply a border.
2. Click Command-E on a MAC and Cntrl-e on windows. This should open the image in Photoshop
3. In Photoshop go to the image menu and find Canvas size. There is a shortcut that you could use shown below.
4. Select the Canvas size and the Canvas Size dialog will open.
5. Use the dropdown to the right of the Width to change to percent
6. Change the percent for both Width and Height to 100.4.
7. Click ok and the border will be Applied.

3



4

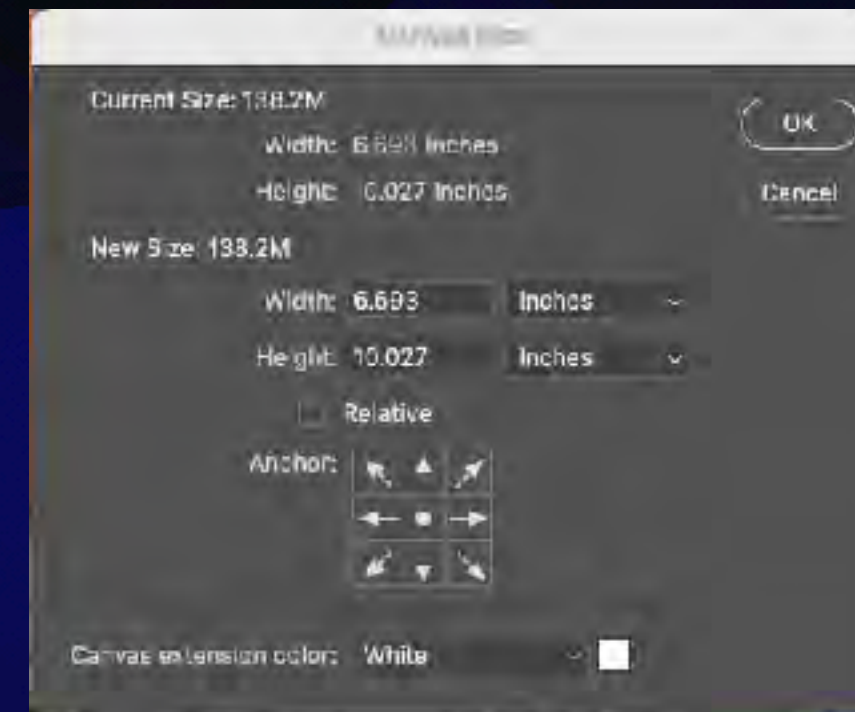

7

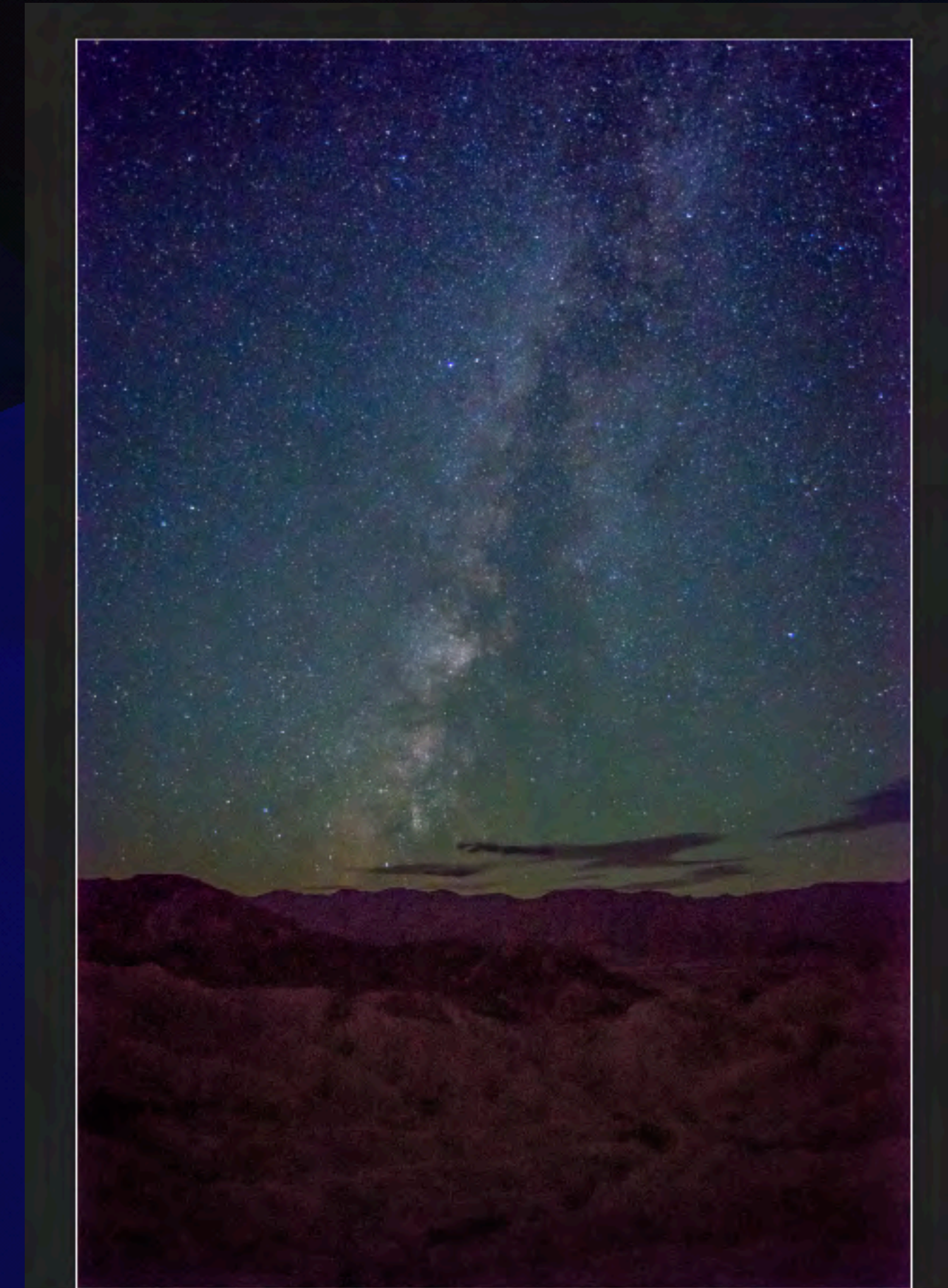

Easy Step to Add a Boarder to a Photo and Export

1. Select Export from File Menu.
2. Then Select Export As
3. The Dialog shown below will open.
4. Change the Format to JPG
5. Set the Quality you want
6. Set the Size of the larger to the Width or Height to the desired output size.
7. Then click the Export button will open.
8. Select the destination for your file and click Save

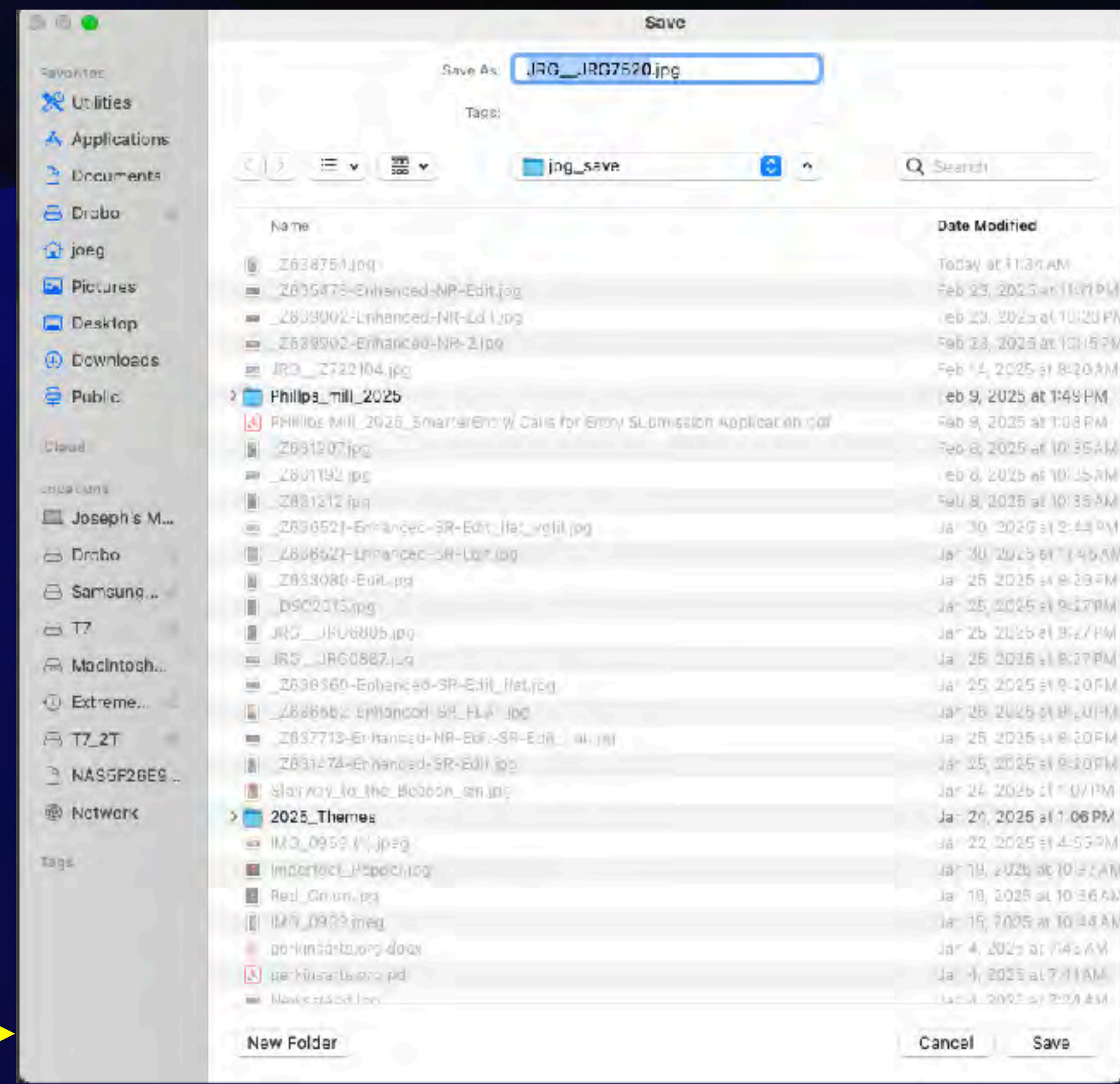
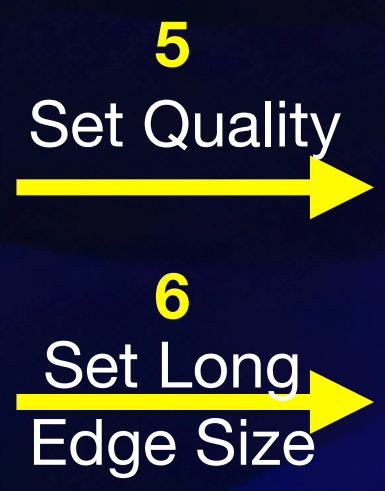
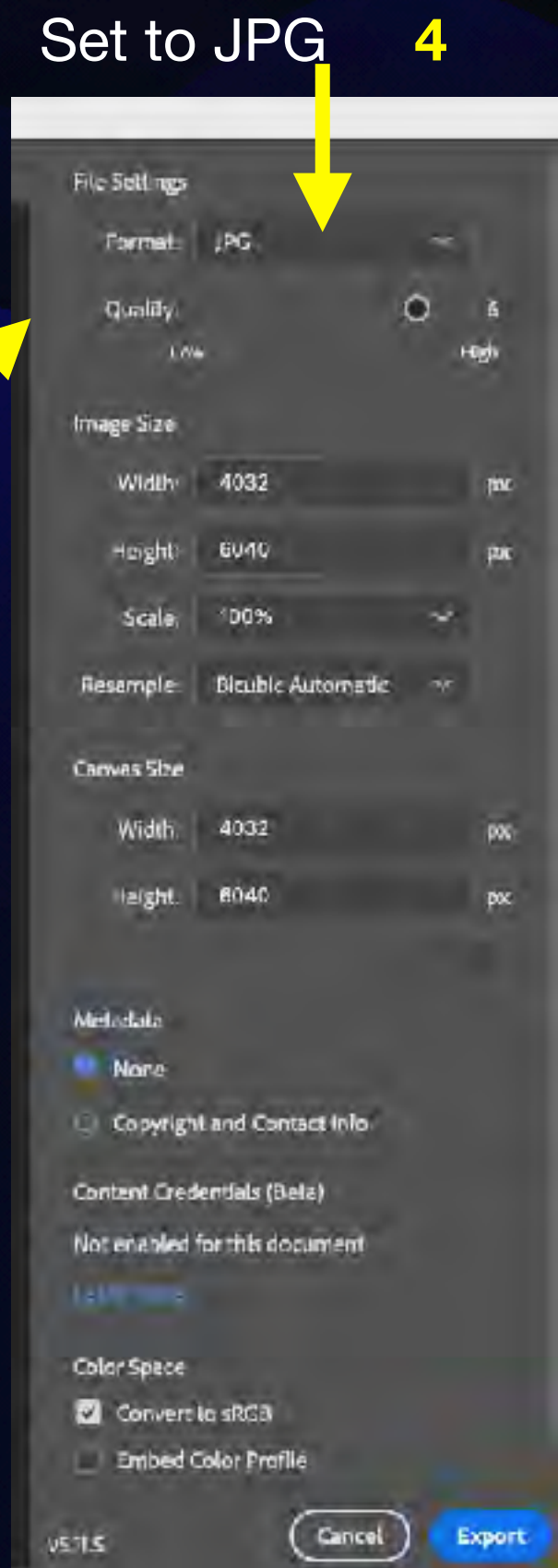

Deletion of Catalog Backups

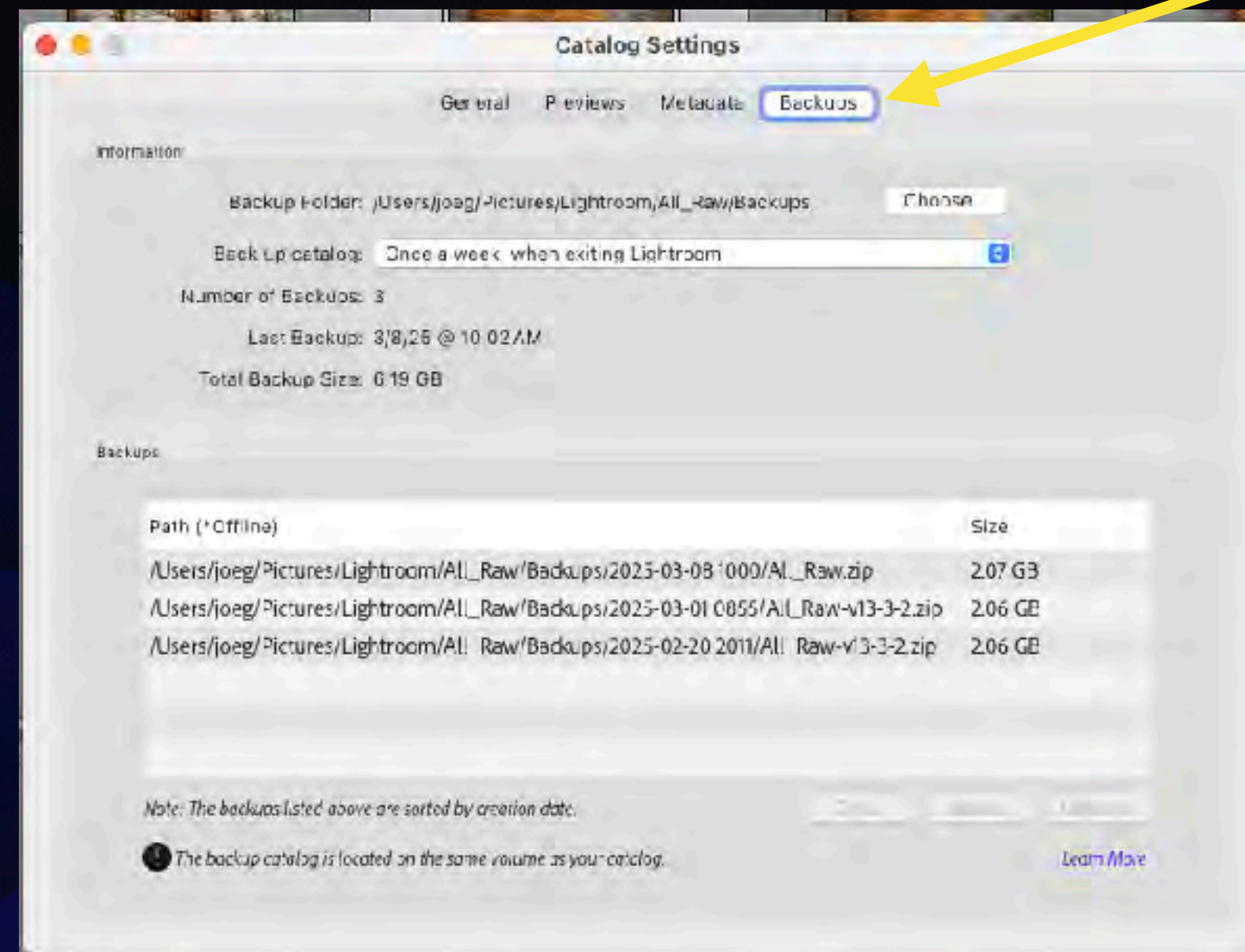
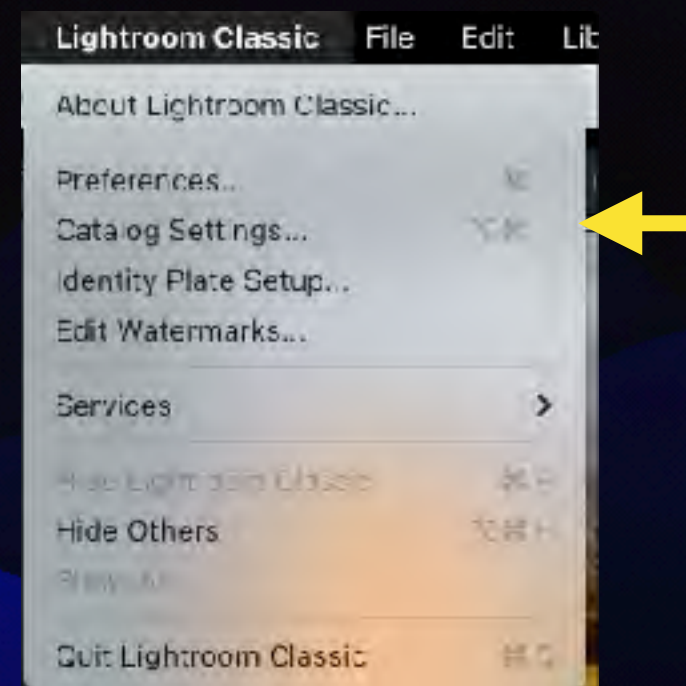

Rename a Catalog After a Catalog Upgrade

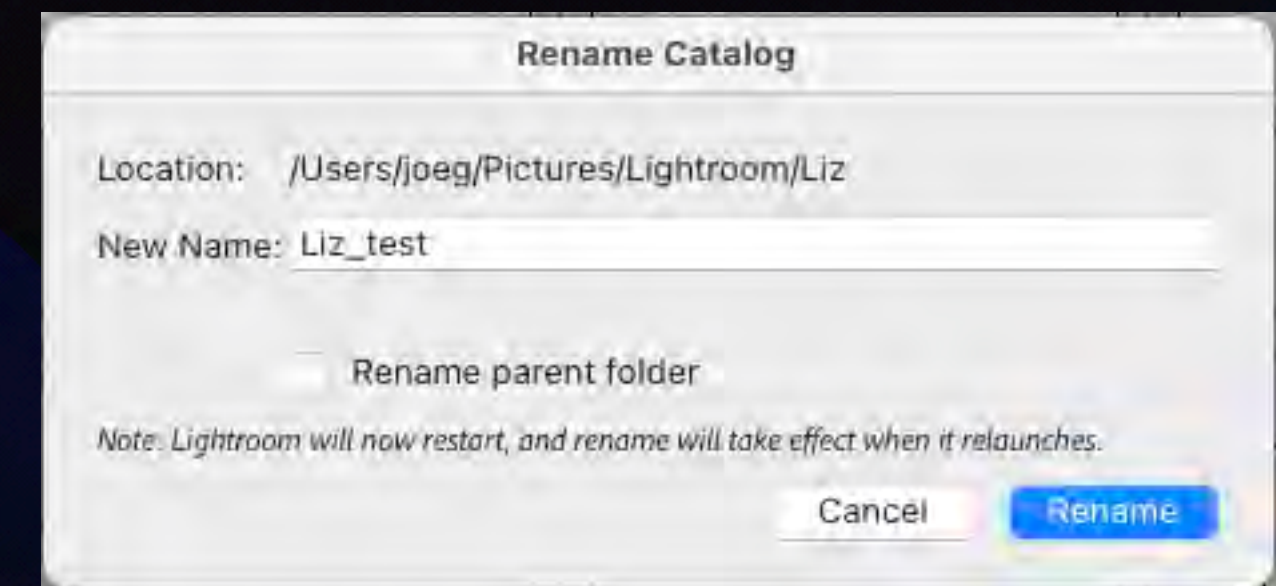
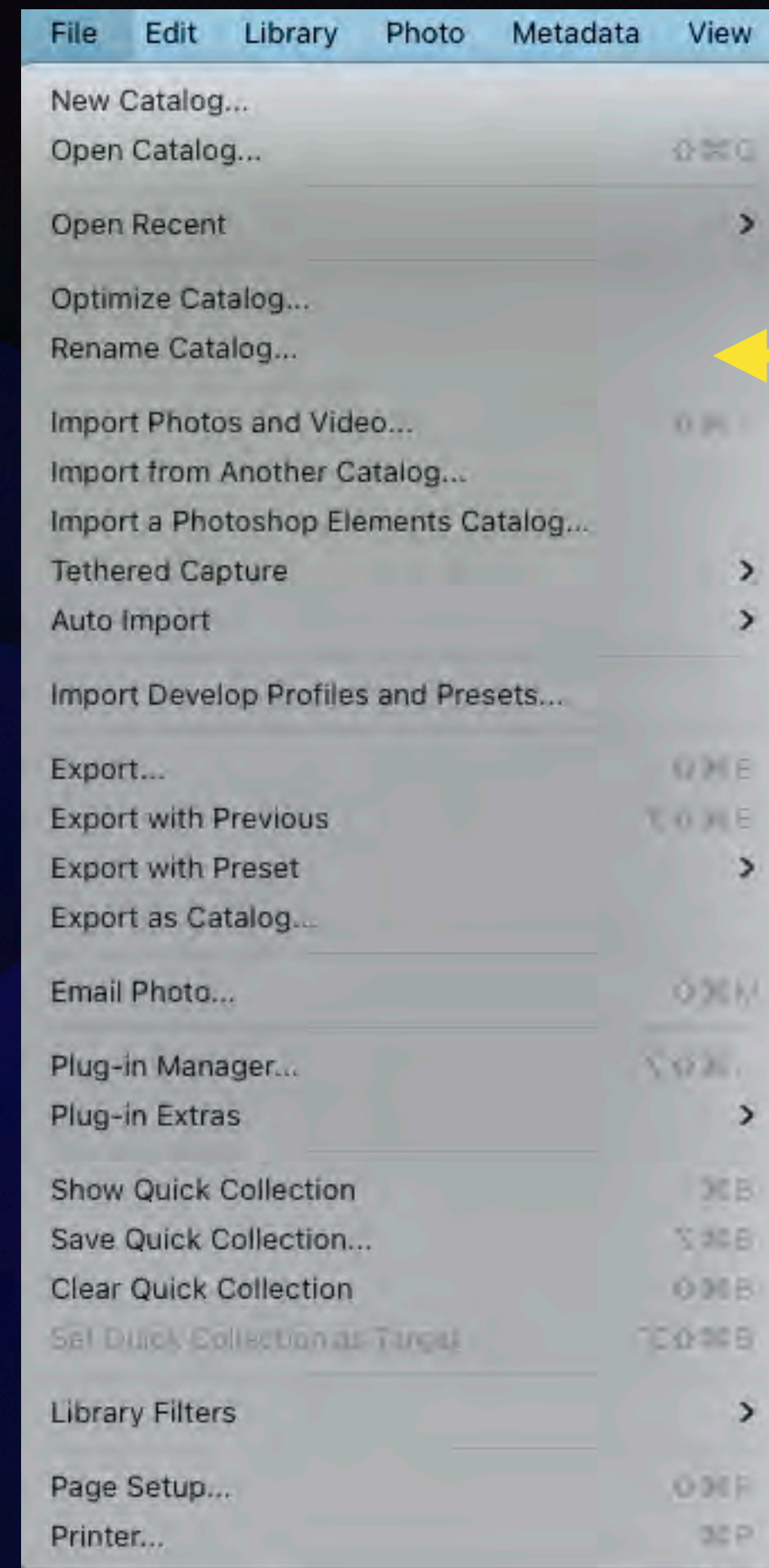
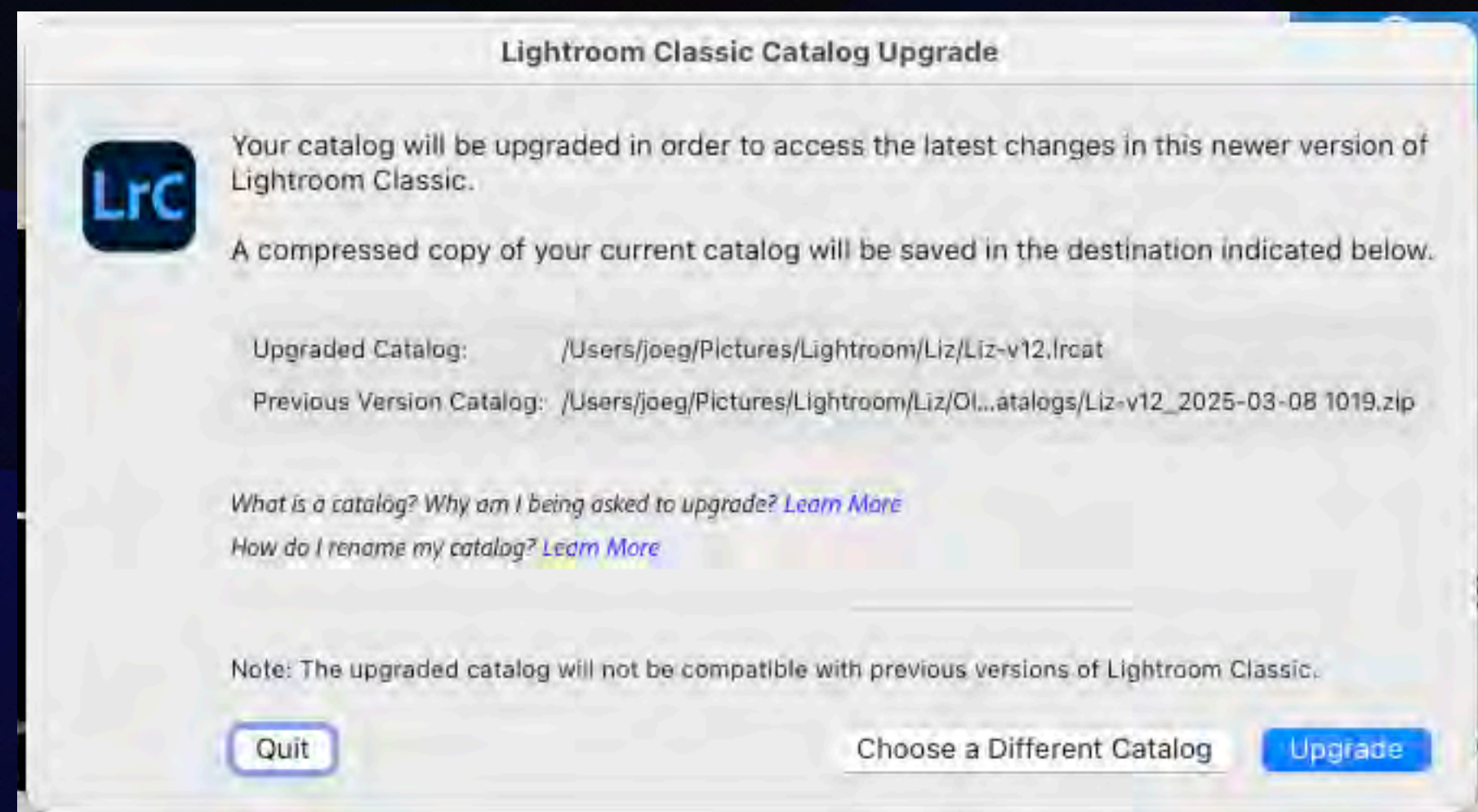

If an Older catalog exists with the name you are changing it to, that older catalog should be deleted first.

Lightroom will close and reopen with the changed catalog name